

Courtesy Of Michael E Grekul Of MaxWell Progressive

\$285,000 - 323 503 Albany Way, Edmonton

MLS® #E4426751

\$285,000

2 Bedroom, 2.00 Bathroom, 926 sqft
Condo / Townhouse on 0.00 Acres

Albany, Edmonton, AB

Aviva Condominiums, a modern, elegant design both inside and out! This 2 bedroom/2 bath apartment has tall ceilings & is well laid out with a spacious great room living area hosting a functional kitchen w/chocolate cabinets w/crown moulding, stainless appliances, quartz counters with island eating bar, spacious living room w/formal dining table space & easy south facing balcony access. Flooring is engineered hardwood in living areas with carpet in bedrooms & ceramic tile in bathrooms. Primary bedroom has plenty of room for a king bed w/walk in closet & ensuite bath. Second bedroom located next to the common 4 pc bath. Entry area hosts a coat closet, desk/bar area, & large storage room w/stacker washer dryer. There are 2 titled parking stalls included with one in the heated u/g parkade with storage locker & 2nd is an energized surface stall. Building amenities include social areas, gym & party room. Extremely well located to all essential services, public transportation and easy access to the Henday.

Built in 2016

Essential Information

MLS® # E4426751

Price \$285,000

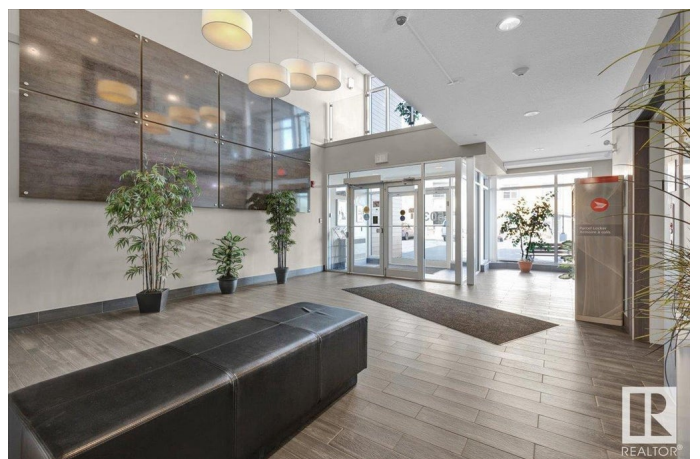
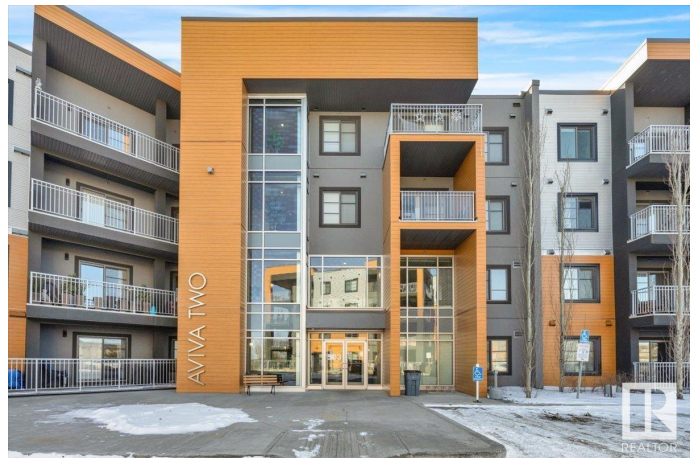

Bedrooms	2
Bathrooms	2.00
Full Baths	2
Square Footage	926
Acres	0.00
Year Built	2016
Type	Condo / Townhouse
Sub-Type	Lowrise Apartment
Style	Single Level Apartment
Status	Active

Community Information

Address	323 503 Albany Way
Area	Edmonton
Subdivision	Albany
City	Edmonton
County	ALBERTA
Province	AB
Postal Code	T6V 0M5

Amenities

Amenities	Exercise Room, Parking-Visitor, Social Rooms
Parking Spaces	2
Parking	Parkade, Stall, Underground

Interior

Interior Features	ensuite bathroom
Appliances	Dishwasher-Built-In, Dryer, Microwave Hood Fan, Refrigerator, Stove-Electric, Washer, Window Coverings
Heating	Baseboard, Hot Water, Natural Gas
# of Stories	4
Stories	1
Has Basement	Yes
Basement	None, No Basement

Exterior

Exterior	Wood, Metal, Stucco, Hardie Board Siding
Exterior Features	Public Transportation, Shopping Nearby, View Downtown
Roof	EPDM Membrane, Flat

Construction Wood, Metal, Stucco, Hardie Board Siding
Foundation Concrete Perimeter

Additional Information

Date Listed March 21st, 2025
Days on Market 21
Zoning Zone 27
Condo Fee \$447

DATA IS DEEMED RELIABLE BUT IS NOT GUARANTEED ACCURATE BY THE REALTORS® ASSOCIATION OF EDMONTON. COPYRIGHT 2025 BY THE REALTORS® ASSOCIATION OF EDMONTON. ALL RIGHTS RESERVED. Trademarks are owned or controlled by the Canadian Real Estate Association (CREA) and identify real estate professionals who are members of CREA (REALTOR®, REALTORS®) and/or the quality of services they provide (MLS®, Multiple Listing Service®)

Listing information last updated on April 11th, 2025 at 6:32pm MDT